

CS 240 CLIMBING SCAFFOLD

CS 240 is a crane-dependent climbing system that can be used both as a load-bearing scaffold or as a working and safety scaffold.



At Work For You

HÜNNEBECK 

BY BRAND SAFWAY

For versatile application: The CS 240 climbing scaffold with retractable formwork, available in two different versions: either as CS 240 L for use with wall formwork with through ties in concreting position or as CS 240 H for use on inclined walls up to 30°.

► Product benefits

Versatile

High adaptability and load-carrying capacity of the climbing scaffold

Usable either with frame panel or timber beam wall formwork

Applicable for great heights of more than 100 m

CS 240 H is usable on inclined walls up to 30°.

Economical

Climbing scaffold units can be pre-assembled according to project requirements and arrive on site ready to use

Quick

Quick and effective final assembly of the accessory parts on site

Easy handling

Formwork can be rolled back from concrete by means of move-off unit

Safe

Guardrail posts ensure that all platforms are safe



► Formwork can be rolled back from concrete by means of move-off unit

► Technical data

| Product description | CS 240 L Climbing scaffold |
|---------------------------------|---|
| Platform widths | Working platform 2.40 m Trailing platform 2.02 m Pouring platform 0.82 m |
| Maximum formwork height | 5.40 m |
| Clearance from concrete | Up to 83 cm |
| Relevant standards | Load-bearing scaffolds accord. to EN 12811 Working and safety scaffolds accord. to EN 12811 part 1 |
| Influence width per CS brackets | With 4 m formwork height, up to 4.75 m (depending on wind load) |
| Handling | Crane |
| Formwork | MANTO H 20 wall formwork PLATINUM 100 |
| Application above ground | Up to 100 m and higher (accord. to static calculation) |

| Product description | CS 240 H Climbing scaffold |
|---|---|
| Platform widths | Working platform 2.60 m Trailing platform 2.02 m Pouring platform 1.30 m |
| Maximum formwork height | 5.40 m |
| Clearance from concrete | Up to 95 cm |
| Relevant standards | Load-bearing scaffolds accord. to EN 12811 Working and safety scaffolds accord. to EN 12811 part 1 |
| Influence width per CS brackets | With 4 m formwork height, up to 4.75 m (depending on wind load) |
| Handling | Crane |
| Application above ground | Up to 100 m and higher (accord. to static calculation) |
| Max. formwork height for use as dam bracket | 3.90 m (accord. to static calculation) |
| Inclined walls | Up to $\pm 30^\circ$ (accord. to static calculation) |



◀ Applicable for great heights of more than 100 m

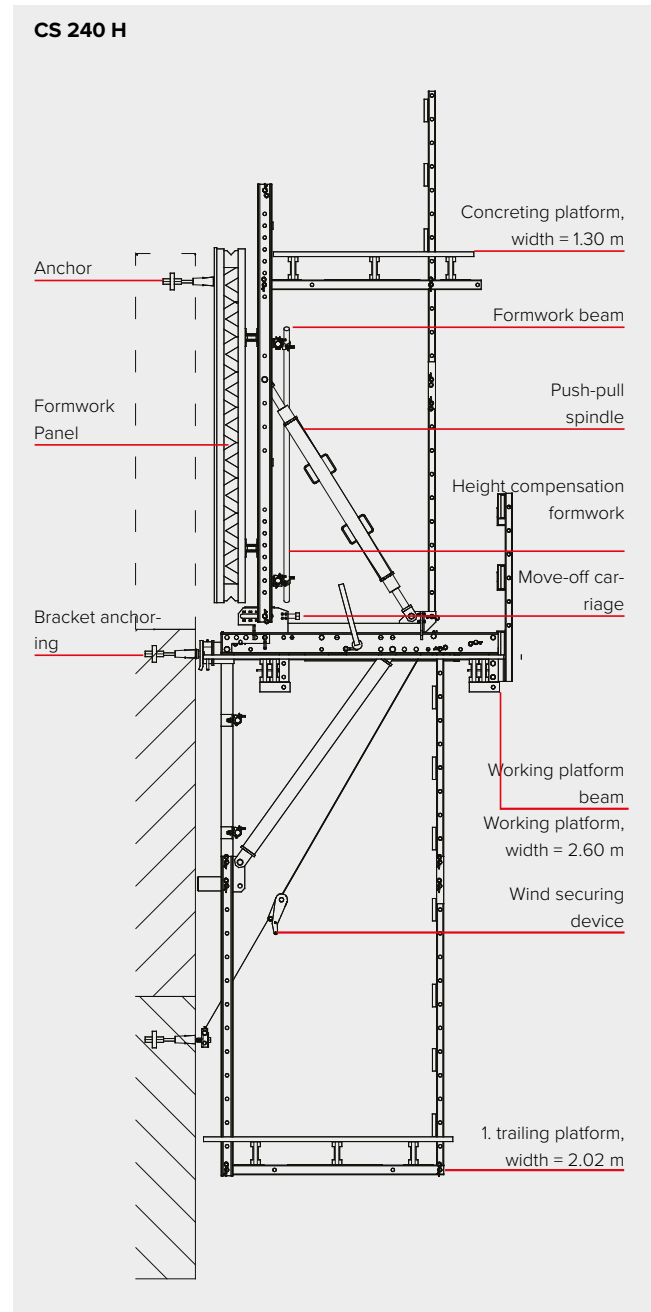
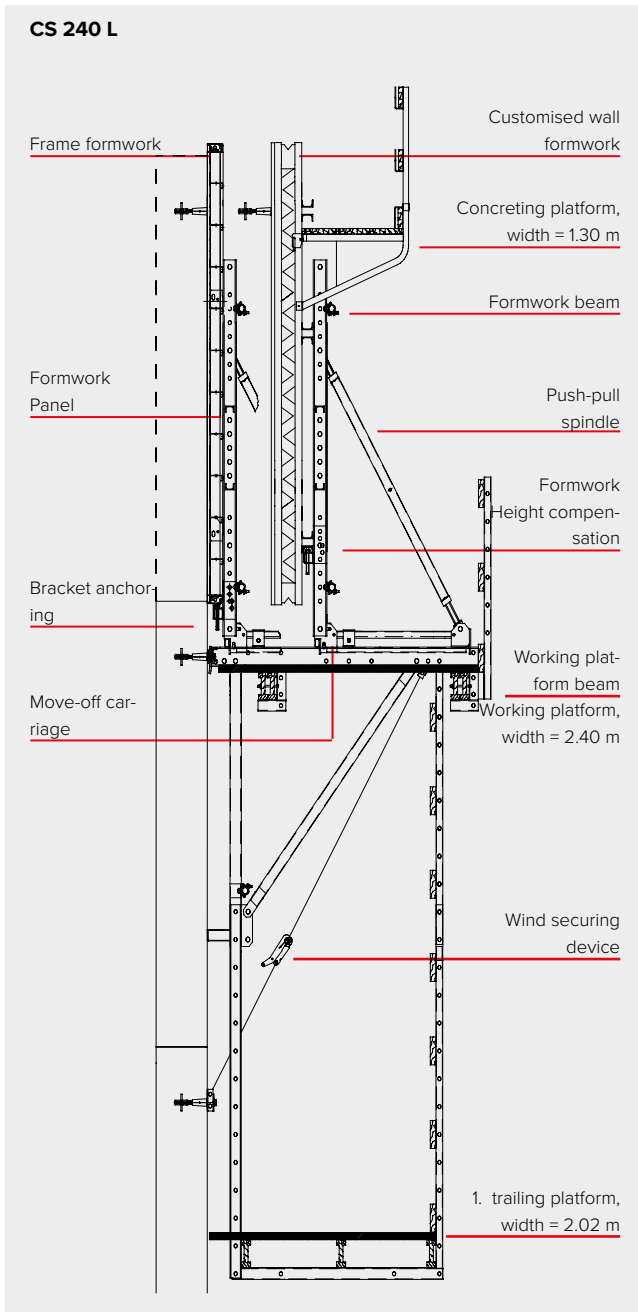

► Overview of the main system components of the CS 240 L and CS 240 H climbing scaffolds with one trailing platform

Application & use

- Wall formwork
- Inclined walls

CS 240 integrates with

- MANTO®
- PLATINUM 100
- H 20 wall formwork