

UNIVERSAL FORMWORK PLATFORM

Bracket Adapter MANTO Edge

Operating Instructions

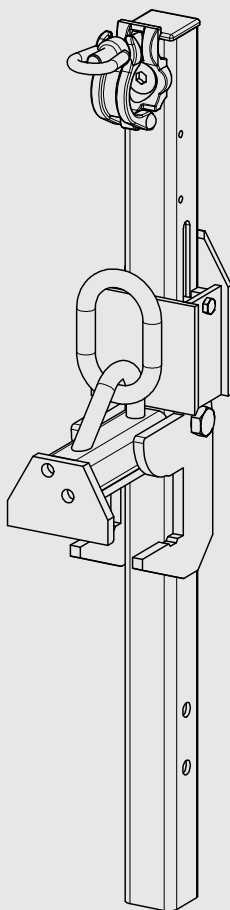

Contents

1	General information	3
1.1	About these instructions	3
1.2	Product description.....	3
1.3	Intended use.....	3
1.4	Other relevant documents.....	3
1.5	Overview.....	4
2	Safety instructions.....	5
2.1	Conventions in this user guide.....	7
3	Before use.....	8
3.1	Functional check	8
3.2	Checking ID plate and inspection tag	8
4	Unlocking Bracket Adapter	10
5	Attaching Bracket Adapter to Universal Formwork Platform.....	11
6	Attaching Bracket Adapter to MANTO formwork elements.....	12
6.1	To vertical formwork elements.....	12
6.2	To horizontal formwork elements	14
7	Attaching Bracket Adapter to crane.....	15
8	Detaching Bracket Adapter from formwork.....	16
9	Technical data	17
10	Inspection instructions.....	17
10.1	Area of application.....	17
10.2	Purpose.....	17
10.3	Responsibility	17

1 General information

1.1 About these instructions

These original operating instructions describe the safe operation of the Bracket Adapter MANTO Edge (code:607780) for the Universal Formwork Platform.

1.2 Product description

The Bracket Adapter MANTO Edge is a component of the Universal Formwork Platform. Using 2no. Bracket Adapters MANTO Edge, 1no. scaffold tube 48.3 mm and 2no. Universal Formwork Platform Crane Suspensions (code:605279), you can

- Transport a Universal Formwork Platform by crane
- Attach a Universal Formwork Platform to the top edge profile of MANTO formwork elements and
- Move MANTO formwork elements along with the Universal Formwork Platform by crane.

The SWL per Bracket Adapter is 600 kg.

1.3 Intended use

The Bracket Adapter MANTO Edge is a lifting accessory. It is used only to transport and attach a Universal Formwork Platform to MANTO or PLATINUM 100 formwork elements.

Bracket Adapter MANTO Edges must always be used in pairs. Always use a scaffold tube to connect the two Bracket Adapters MANTO Edge to one another. The SWL per Bracket Adapter is 600 kg.

1.4 Other relevant documents

These operating instructions focus particularly on safe operation of the Bracket Adapter. Please also observe and comply with the information and instructions contained in the following documents:

- The Universal Formwork Platform user guide
- The user guide for the formwork system used (MANTO or PLATINUM 100)
- The Universal Formwork Platform Crane Suspension operating instructions

1.5 Overview

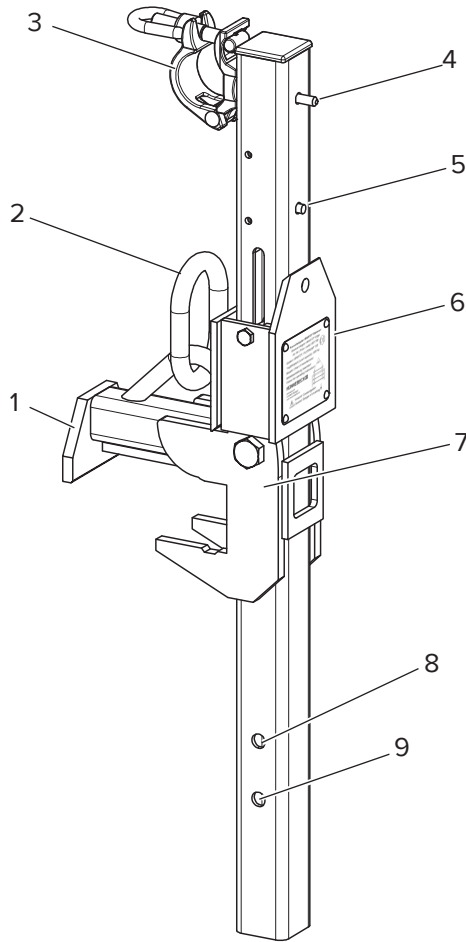

- 1 Limit stop
- 2 Suspension link for transporting by crane
- 3 Coupler with ring nut for scaffold tube
- 4 Operating pin
- 5 Locking pin
- 6 Cage with ID plate
- 7 Profile lock
- 8 Hole for attaching Platform Bracket; overlap position
- 9 Hole for attaching Platform Bracket; standard position

2 Safety instructions

1. The contractor may assign only persons properly trained and familiar with the required tasks as described in the risk assessment and the operating instructions to use the lifting accessories. The operating instructions must be readily available at all times!
2. Do not stand or walk under suspended loads!
3. Do not endanger persons within the swivel range of the crane!
4. Wear appropriate personal protective equipment! Protective gloves that comply with EN 388, minimum performance level 1. Safety footwear S3 that complies with EN ISO 20345 (EN 345) and an industrial helmet that complies with EN 397.
5. Do not impose on the Bracket Adapter weight that exceeds the SWL!
6. Use the Bracket Adapters only in pairs. Brace the two Bracket Adapters with any scaffold tube 48.3 mm to prevent the sling from exerting diagonal pull!
7. Attach the Bracket Adapters only to formwork elements that are in serviceable condition!
8. Attach formwork elements to the hoisting equipment such that they are symmetrical to their centre of gravity!
9. Always use 2no. Universal Formwork Platform Crane Suspensions to move platforms!
10. Never lift platforms with persons or tools on them!
11. Do not hoist formwork elements with loose items on them.
12. Refer to the user guide for the formwork elements and Universal Formwork Platform to be transported for information on assembly and erection of the formwork elements.
13. Before transporting stacked formwork elements, check all connectors and connections between the elements! Verify that the number of connectors is correct!
14. When lifting the formwork into place, secure the formwork elements to prevent uncontrolled motion!
15. The points at which the Bracket Adapters are attached to the formwork elements have to be free of dirt and concrete and be undamaged!
16. Lift, transport and set down loads in a manner that prevents them from unintentionally tipping over, falling apart or slipping!
17. Do not move loads when the wind speed is greater than 15 m/s or 54 km/h (Bft 7)! The load must be able to be transported safely!
18. Lift, transport and set down loads such that the Bracket Adapter is not damaged.
19. Do not attach the crane hook directly to the lifting eye on the Bracket Adapter! Use only a suitable sling attached to the integrated lifting eye on the Bracket Adapter to hoist it!

Safety instructions

20. The sling hook must move freely in the Bracket Adapter lifting eye!
21. The angle of the slings on the crane hook may not exceed 60°. Do not knot steel wires and steel chains. Untangle twisted chains before attaching them!
22. Visually inspect the Bracket Adapters before each use and during operation, checking for faults such as deformation, cracks, breaks, incomplete labelling, etc.
23. Store the Bracket Adapters such that they are protected from weather conditions and aggressive substances.
24. The contractor is responsible for ensuring that a Bracket Adapter with defects that could in any way affect safety is not used!
25. The contractor is responsible for having repairs to lifting accessories performed only by the manufacturer. Use only original spare parts!
26. The contractor must ensure that, before operation begins, the lifting accessory has been inspected by a qualified person and that no deficiencies have been found! Check the inspection date before each use!
27. The contractor is responsible for having the lifting accessory inspected by a qualified person at least once a year!
28. When damage or other extraordinary circumstances that could affect the SWL have occurred, the contractor is responsible for having the lifting accessory inspected by a qualified person!

2.1 Conventions in this user guide

2.1.1 Warnings and notes



DANGER

Danger!

Danger indicates a hazardous situation that, if not avoided, will cause death or serious injury.



WARNING

Warning!

WARNING indicates a hazardous situation which, if not avoided, could result in death or serious injury.



CAUTION

Caution!

Caution indicates a hazardous situation that, if not avoided, can cause minor or moderate injury.

NOTE

Note!

Note indicates a hazard that can cause property damage.



This note indicates that an additional inspection is required.



This note shares practical experience with the user, e.g. how to perform a task more easily or quickly.



This note indicates particularly important information, e.g. that a requirement has to be fulfilled.



This symbol indicates that additional information from other documents is required. These documents could be user guides or operating instructions for other products.

2.1.2 Instructions

In this user guide instructions are always identified with the word **Step**, e.g.

Step 1 Insert the locking bolt into the bore from the outside.

Step 2 Secure the pin with the spring cotter pin.

3 Before use

Perform a functional check before every use. Also check the ID plate and inspection tag.

3.1 Functional check

Before every use of the Bracket Adapter, check the following features:

- The profile lock and cage move freely and the cage locks the profile lock.
- The Bracket Adapter hooks easily to the formwork element, without exerting force.
- The profile lock closes easily around the edge profile of the formwork element.
- The limit stop grasps over the upper profile and the form sheet on the formwork element.

If for whatever reason one or more of these features cannot be checked as described here, the Bracket Adapter must be inspected and repaired by the manufacturer or an authorised agent.

3.2 Checking ID plate and inspection tag

Before every use of the Bracket Adapter, check that the ID plate and the inspection tag are in place and legible. If the ID plate or inspection tag is missing or illegible, the Bracket Adapter may not be used.

The Bracket Adapter may be operated only if it has been inspected within the last year.



ID plate missing or illegible!

The Bracket Adapter may not be used if the identification tag is missing or illegible. The manufacturer or an authorised agent must then inspect the equipment and issue a new plate.



Inspection tag missing!

The Bracket Adapter may not be used if the inspection tag is missing or illegible. The manufacturer or a qualified person must then inspect the equipment and issue a new tag. This applies only to HÜNNEBECK rental equipment pursuant to test certification as specified by DGUV (German statutory accident insurance regulations) 100-500*. The German ordinance on industrial safety and health (BetrSichV) applies to the use of equipment that is not rented.



Comply with prescribed area of application!

* Test certification as specified by DGUV applies!

Bracket Adapter MANTO Edge

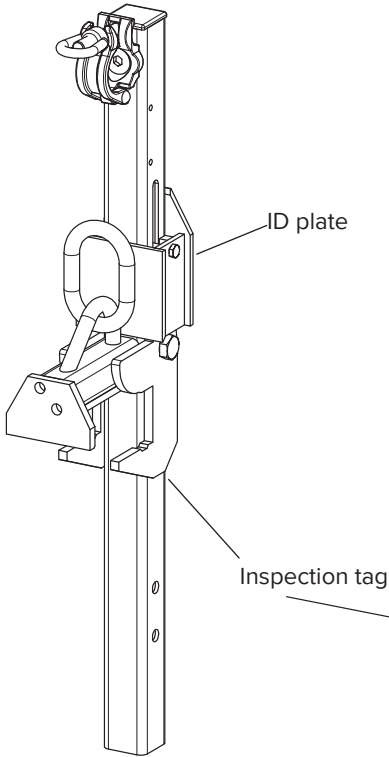

Konsoladapter MANTO® Rahmen
Bracket Adaptor MANTO® Edge
Art.-Nr. (Prod. code): 607 780 

System: MANTO®, PLATINUM® 100
Tragfähigkeit (Load capacity): 600 kg
Baujahr (Year of manufacture):
Betriebsanleitung beachten!
Follow the operating instruction!

HUNNEBECK 

Rehhecke 80
D-40885 Ratingen
www.hunnebeck.de



 Vorsicht! Quetschgefahr
Caution! Danger of crushing 

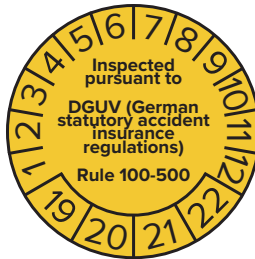

Unlocking Bracket Adapter

4 Unlocking Bracket Adapter

The Bracket Adapter has to be unlocked before it can be mounted to a formwork element.



CAUTION

Risk of crushing!

The Bracket Adapter cage is spring-loaded and can drop quickly. This can crush your fingers. Keep hands out of the range of motion of the cage.

Wear gloves!

- Step 1** Slide the cage far enough up that the profile lock is free. The profile lock opens.
- Step 2** Slide the cage down again. The Bracket Adapter is now unlocked and can be attached to a panel.

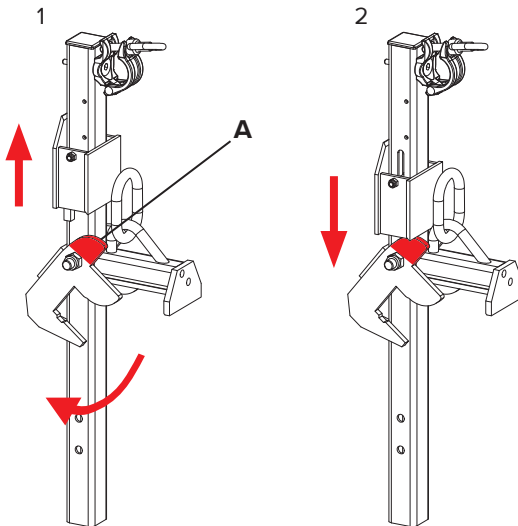

5 Attaching Bracket Adapter to Universal Formwork Platform

Attach the Bracket Adapter to the Uni Platform Brackets (code:607700) on the Universal Formwork Platform. The Bracket Adapters have two holes where parts can be attached: the positions Standard and Compensation (Refer to page 4). Use Standard for normal applications. Use Overlap when a formwork platform should overlap an adjacent formwork platform.

Step 1 Attach the Bracket Adapter (**A**) to the Uni Platform Bracket (**B**) with the pin $\varnothing 12$ mm. Secure the Pin with a Spring Cotter Pin.

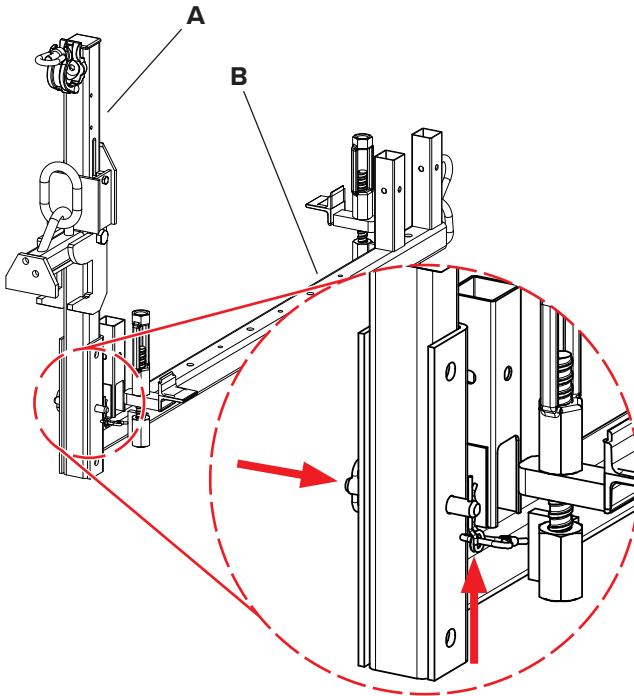

Step 2 Install the second Bracket Adapter in the same way.

Step 3 Brace the Bracket Adapter with any scaffold tube 48.3 mm. To do this, open the couplers for the scaffold tube, place the scaffold tube in the couplers and close the couplers. Torque 50 Nm. Use the tip of a roofing hammer to tighten the ring nuts. The tube may not be longer than the width of the formwork assembly to be lifted.

6 Attaching Bracket Adapter to MANTO formwork elements

6.1 To vertical formwork elements

Step 1 Unlock both Bracket Adapters MANTO Edge as described on page 10 and place them on the formwork.

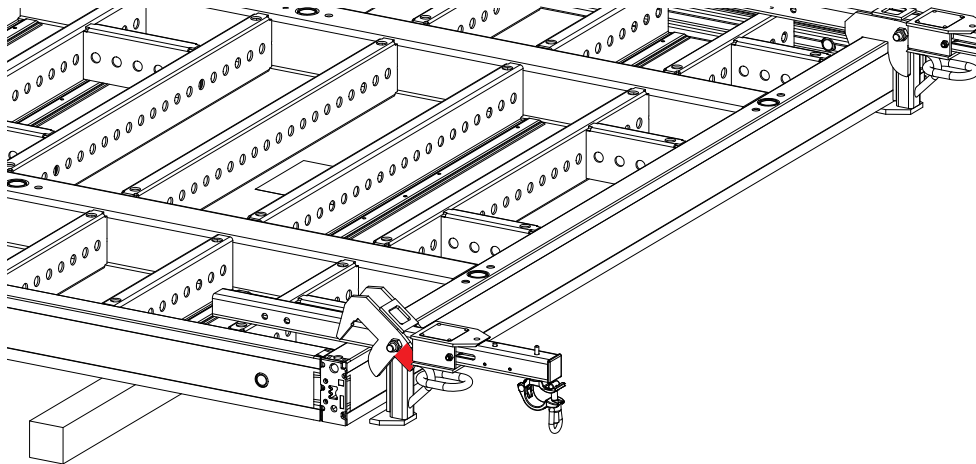

Step 2 Push the Bracket Adapters against the edge profile of the formwork as shown, until the Bracket Adapters lock. The red mark is no longer visible.

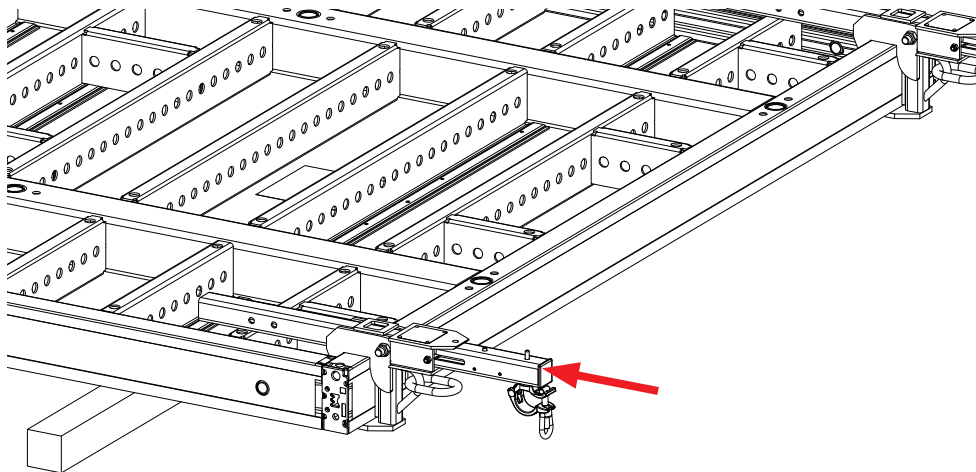

Step 3 Brace the Bracket Adapter with any scaffold tube 48.3 mm. To do this, open the couplers for the scaffold tube, place the scaffold tube in the couplers and close the couplers. Torque 50 Nm. Use the tip of a roofing hammer to tighten the ring nuts. The tube may not be longer than the width of the formwork assembly to be lifted.

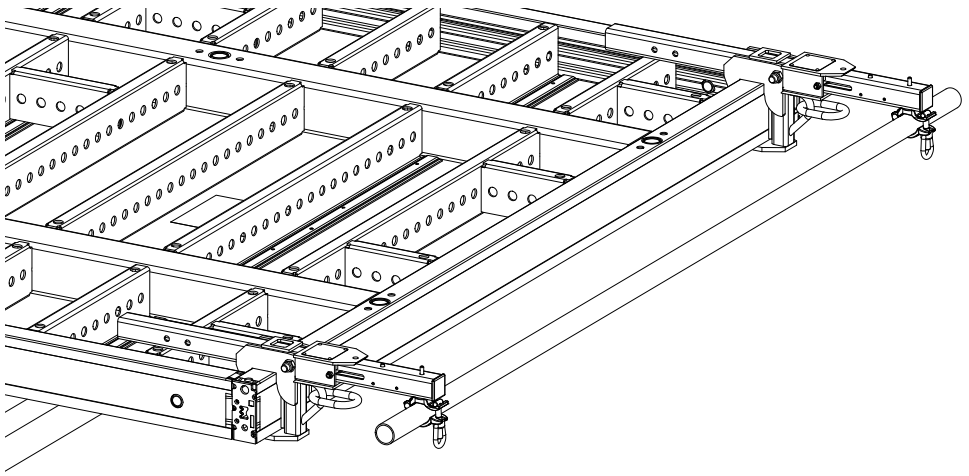

6.2 To horizontal formwork elements

When the formwork elements are horizontal, the Bracket Adapters always have to be attached over an H-rib. The process for attaching them is identical (Refer to section 6).



The checkmarks in the following illustration show all the mounting positions of the Bracket Adapter that are technically possible. However, not all of these positions make sense for attaching the Universal Formwork Platform.

When assembling the Universal Formwork Platform, ensure that no planks project more than 60 cm beyond the edge of the structure!

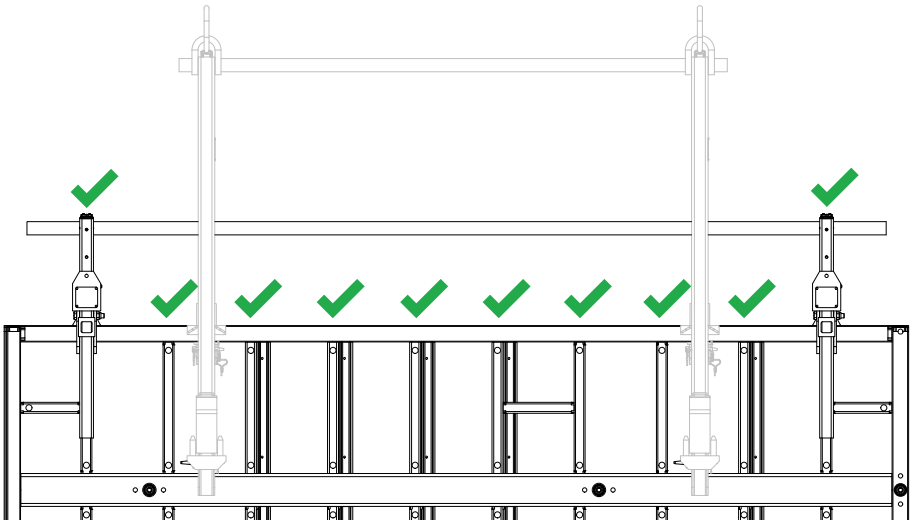

7 Attaching Bracket Adapter to crane

The total weight of a panel assembly always has to be determined before the panel assembly is moved. Include the weight of all of the components and connectors. Do not overload the Bracket Adapter!



WARNING

Risk of serious injury from falling formwork elements!

Do not attach the crane hook directly to the Bracket Adapter!
Always use a suitable sling, e.g. a two-strand chain sling!



Select the quantity and position of connectors as specified in the formwork system user guide and the Universal Formwork Platform user guide!

Additional information on potential applications, transport by crane and the sling to be used can be found in the Universal Formwork Platform user guide.

Always follow the instructions in the Universal Formwork Platform Crane Suspension (code:605279) manual!

Step 1 Connect 2no. strands of a 4-strand suspension to the Bracket Adapter lifting eyes.

Detaching Bracket Adapter from formwork

- Step 2** Using 2no Universal Formwork Platform Crane Suspensions (code:605279), attach the other 2no. strands to the Platform Bracket lifting eyes (red chain link when platform is transported with formwork).

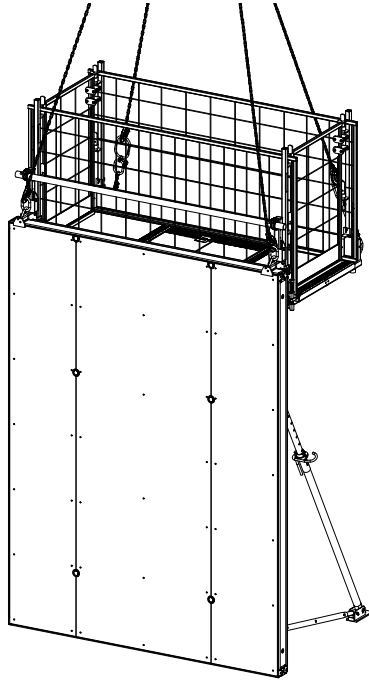

- Step 3** Lift the load.

8 Detaching Bracket Adapter from formwork

Proceed as follows to remove the Bracket Adapters from the formwork.

- Step 1** Unlock the Bracket Adapters as explained on page 10.
- Step 2** Detach the Bracket Adapter from the formwork.

9 Technical data

Length:	795 mm
Width:	116 mm
Height:	211 mm
Weight:	11.8 kg
Maximum load-bearing capacity per Bracket Adapter:	600 kg

10 Inspection instructions

10.1 Area of application

The German ordinance on industrial safety and health (BetrSichV), §3 sec. 3 and §10 applies to the type, scope and intervals of mandatory inspections as well as to the requirements pertaining to the persons tasked with performing the inspections.

The test certificate items stated here serve as a guideline for inspecting equipment before it is used for the first time and for regular inspections of the Bracket Adapter MANTO Edge.

10.2 Purpose

Inspecting the Bracket Adapter is intended to ensure operating and functional safety of the equipment. The inspections and tests are performed to systematically detect and remedy faults relevant to safety.

Inspections should be performed at regular intervals, occurring at least once a year. If the operating conditions require otherwise, inspections can be performed more frequently. This applies e.g. when the equipment is used very frequently, when there is excessive wear or under special operating conditions such as in a corrosive environment.

10.3 Responsibility

The user is responsible for scheduling regular safety inspections of the Bracket Adapter. Safety inspections of this equipment should be performed only by qualified persons (qualified person as specified by DGUV (German statutory accident insurance regulations) regulation 54, §23).

Inspection instructions

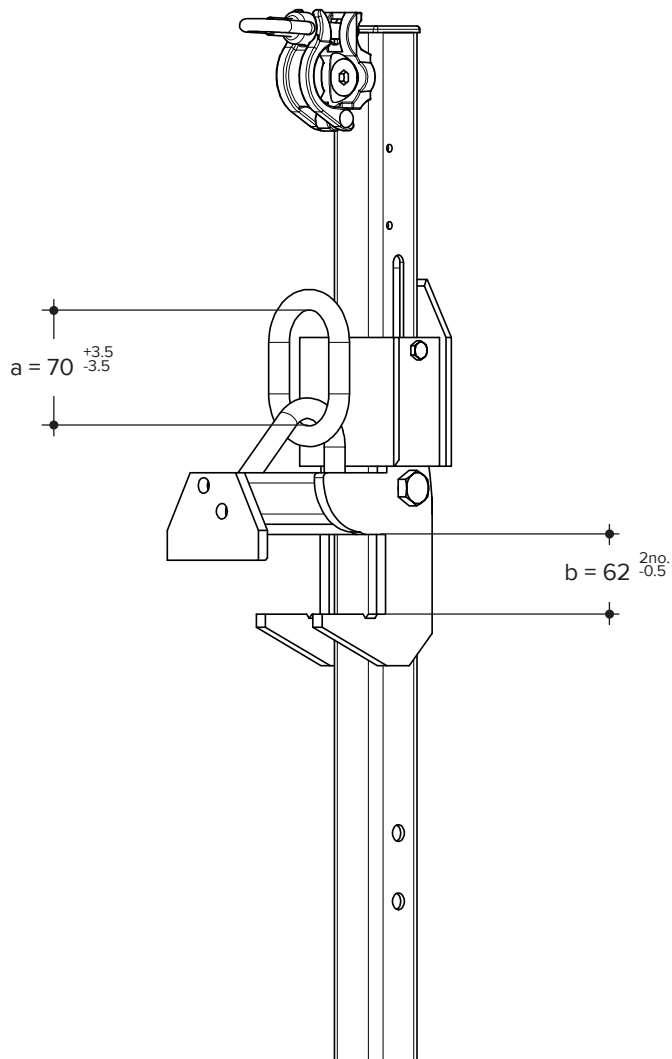

11 Test certificate for Bracket Adapter MANTO Edge

Part code:	607780
Serial number:	<input type="text"/> <input type="text"/> <input type="text"/> <input type="text"/>
Year of manufacture:	<input type="text"/> <input type="text"/> <input type="text"/> <input type="text"/>
Functional check pursuant to section 3.1 passed:	<input type="checkbox"/>
Weld seams visible, no external cracks or damage detectable:	<input type="checkbox"/>
No deformation of housing, cage and profile lock:	<input type="checkbox"/>
Scaffold couplers complete, including T-head bolt and ring bolt:	<input type="checkbox"/>
All screw connections in place and checked for tightness:	<input type="checkbox"/>
No corrosion damage that could affect functioning or safety:	<input type="checkbox"/>
Bracket Adapter free of concrete residue:	<input type="checkbox"/>
ID plate in place and legible:	<input type="checkbox"/>
Test documented by inspection tag with month/year according to year of test:	<input type="checkbox"/>
Data bag containing operating instructions	<input type="checkbox"/>
Clear opening of suspension link (dimension a) 70 ± 3.5 mm:	<input type="checkbox"/>
Profile lock opening (dimension b) $62 - 0.5 / +2$	<input type="checkbox"/>

Repairs may be made only by the manufacturer, and only original spare parts may be used!

The German trade association dictates only visual inspection.

Date

Inspector

EU-Konformitätserklärung

Hersteller

HÜNNEBECK GmbH
Rehecke 80
D-40885 Ratingen
Tel: +49 (0) 2102 937-1
Fax: +49 (0) 2102 37651

erklärt hiermit, dass das nachfolgende Produkt aufgrund seiner Bauart und in der von HÜNNEBECK in Verkehr gebrachten Ausführung allen einschlägigen Bestimmungen der nachfolgend aufgeführten Richtlinien und harmonisierten Normen entspricht. Bei einer Änderung des Produkts ohne unsere Zustimmung verliert diese Erklärung ihre Gültigkeit.

Produktbezeichnung

Konsoladapter MANTO Rahmen

Artikelnummer

607780

Produktbeschreibung

Lastaufnahmemittel zum Transport von Universal Schalungsbühnen mit oder ohne daran montierten MANTO oder PLATINUM 100 Schalelementen. Verbindungsmittel zur Montage von Universal Schalungsbühnen an MANTO oder PLATINUM 100 Schalelementen.

Richtlinien

2006/42/EG (Maschinenrichtlinie)

Harmonisierte Normen

- DIN EN 1677-1:2009-03 und 1677-4:2009-03
- DIN EN ISO 12100:2010
- DIN EN 13155:2003+A2:2009
- DIN EN ISO 13857:2008

Ratingen, den 17.08.2020
HÜNNEBECK GmbH

Unterzeichner:

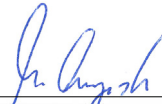
ppa. Mario Ariyoshi
Technischer Direktor

i. A. Matthias Tolls
Projektleiter

Bracket Adapter MANTO Edge

Bracket Adapter MANTO Edge

Hünnebeck
Deutschland GmbH
Rehhecke 80
D-40885 Ratingen
+49 2102 9371
info_de@huennebeck.com
www.huennebeck.de

The copyright to this document belongs to BrandSafway. All the trademarks named in this document are the property of BrandSafway, unless marked as third-party rights or identifiable as such in another way. Hünnebeck, SGB and Aluma Systems are trademarks of BrandSafway. Furthermore, all rights are reserved, particularly with regard to patent grant or utility model registration. Unauthorised use of this document, of the brands contained herein or of other property rights is expressly prohibited and constitutes a violation of copyrights, trademark law or other industrial rights.

The illustrations contained in this document reflect normal operation at a construction site and are not always correct in regard to safety issues.

Last modified June 2020
Keep for later use!